



DEEP ROOF LIGHTING INC.
55 Sea Cliff Avenue, Glen Cove, NY 11542
P.O. Box 520191, Flushing, NY 11352
Tel: 516-676-9100, 9101, 9103, 9105, 9106
Fax: 516-676-9109

[Web Site: www.deeprooflighting.com](http://www.deeprooflighting.com)
[Email: deeproof@aol.com](mailto:deeproof@aol.com) jay@deeprooflighting.com

Stylish Strip Shop lights

ETL DLC



Metal SHOP LIGHT

- **With pull chain switch**
- **Also for Ceiling Mount**
- Easily use, can be plug into power socket.
- Instant on to full brightness.
- Input Voltage: 120V, 50/60Hz.
- CRI(Ra)>80, Beam Angle> 120°.
- ETL/cETL/listed. 50,000 Hrs, 5 years warranty.

- **Shell materials:** Pastic+Aluminum
- **Color:** Sliver
- **Joint seamless or link cable**

8 units 4 feet

4 Feet

Power	40W	Lighting Angle	>120°
Input Voltage	AC120V	LED Brightness Decay	<5%/6000 hrs
PF	>0.9	Working Life	>50000 hrs
Driver Efficiency	>90%	Working Temperature	-30 - +45°C
Luminous Flux	4000LM	Storage Temperature	-40 -+80°C
Color Temperature	3000K/4000K 5000K/6000K/6500K	Protection Level	IP40/Damp Location
CRI	Ra>80	Cable	20AWG

8 Feet

Power	80W	Lighting Angle	110°
Input Voltage	AC120V	LED Brightness Decay	<5%/6000 hrs
PF	>0.9	Working Life	>50000 hrs
Driver Efficiency	>90%	Working Temperature	-30 - +45°C
Luminous Flux	8800LM	Storage Temperature	-40 -+80°C
Color Temperature	3000K/4000K/5000K/	Protection Level	IP40/Damp Location
CRI	Ra>80	Cable	20AWG
Linkable use	Max 7 pcs		

ITEM CODES

LLSS-440-A(30/40/50)	4 feet, 40W, 4400 lumen, Non-dimm, 3000/4000/5000K
LLSS-880-A(30/40/50)	8 feet, 80W, 8800 lumen, Non-dimm, 3000/4000/5000K
LLSS-LK	Link cord, 47.2 inches
LLSS-EJ	End to end joiner, inside package
LLSS-CHAIN	Hanging chain 17", Inside package
LLSS-PK	Power cable 47.2", Inside package
LLSS-CM	Ceiling Mount accessory



Package content

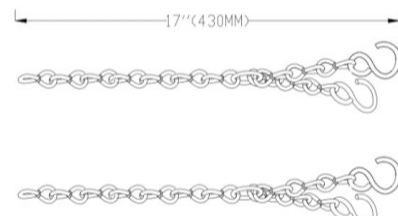
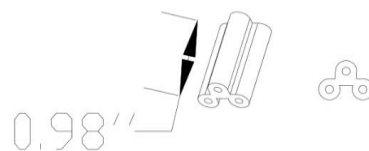
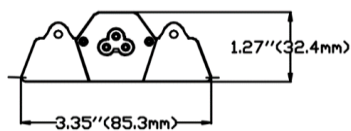
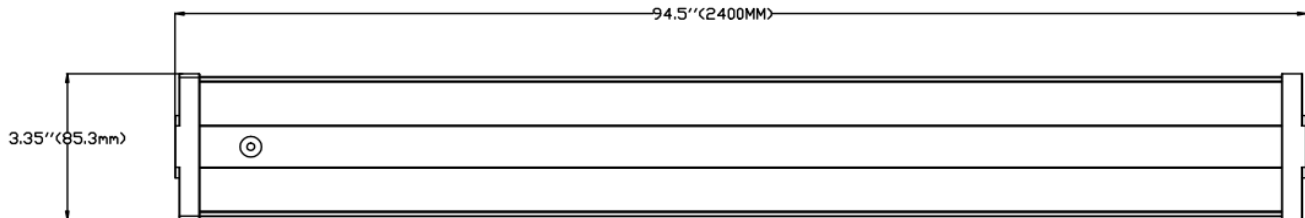
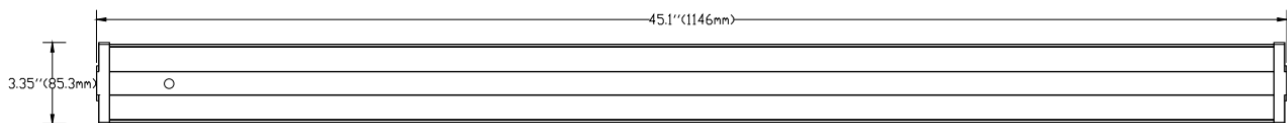

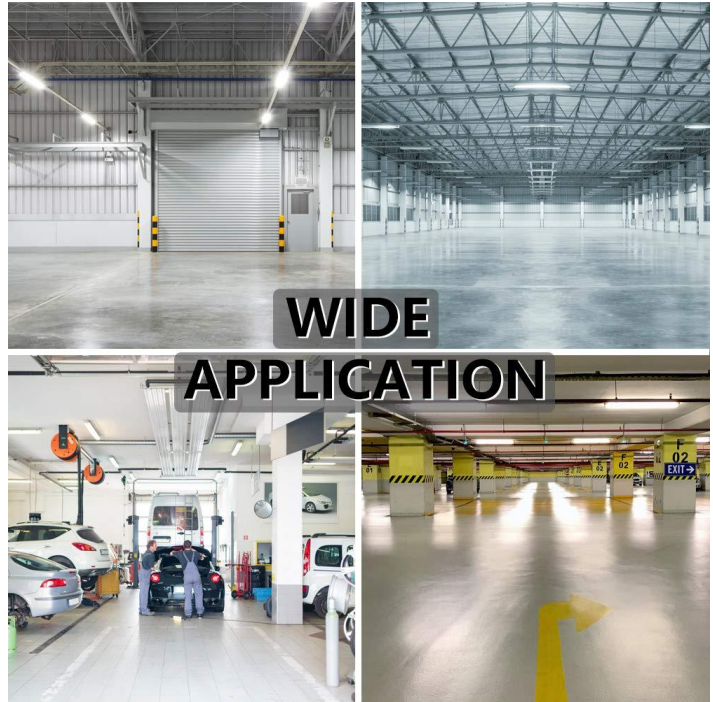

WIDE APPLICATION

CHAIN AND HOOK MOUNTING

1 Drill holes

Drill two holes in the ceiling, distance between the two holes is 43 in

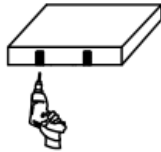

2 Install Mounting Hooks

Fix the mounting hooks to the ceiling .

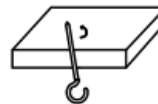

3 Attaching the light to the chain

Attach the S hook at the bottom of mounting chain (AA) to the hanger on the light fixture. Repeat this step on the other of the fixture.

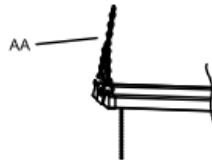

4 Attaching the chain to the ceiling

Hang the fixture body by placing one chain (AA) over each hook (not included) that has been installed on the ceiling.

Adjust chains to level light. The fixture must hang at least 3 in. from the ceiling.

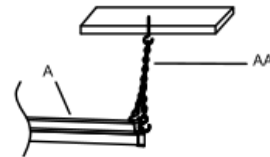

5 Plugging into a power supply

Unit intended to be installed directly beneath a ceiling-mounted receptacle. The wire shall be attached to the chains with supplied cable ties. After installation, plug the power cord onto an electrical outlet. Pull the chain down to turn the on and off.

