

IP65 LED TRI-PROOF LIGHT

LED Linear Linkage Indoor/Outdoor Lights



IP65 LED Tri-proof Light



Features

1. IP65 with waterproof, dustproof and anti-corrosion
2. High light source efficiency and constant current output design, greatly extends the lighting fixture's lifespan.
3. Integrated streamline light source structure makes the light even and soft
4. Anti seismic materials and damping structure
5. Perfect heat dissipation and low temperature design
6. Multifunctions optional: Emergency, Dimming(Triac Dimming&0-10V Dimming), Microwave sensor function, Linkable functions, Microwave Sensor with emergency function, Dimming with emergency function and Microwave Sensor with dimmable function.

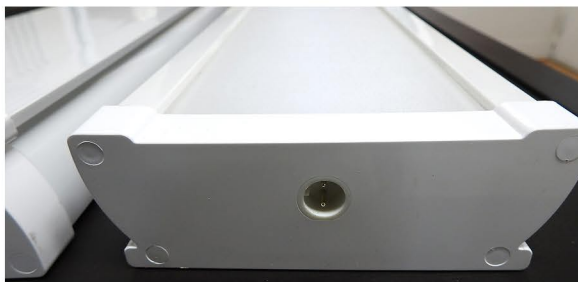

IP65 LED TRI-PROOF LIGHT

LED Linear Linkage Indoor/Outdoor Lights



Product: 40W LED Tri-proof Light

- Material: PET+PC
- Beam Angle: 120 degree
- Power Consumption: 40W
- IP Grade: IP65
- Input Voltage: AC100~277V
- Housing Material: PET
- Power Frequency: 50~60Hz
- Power Factor: >0.9
- Color Rendering Index: Ra>80
- LED Node Temperature: $\leq 60^{\circ}\text{C}$
- Housing Temperature: $\leq 50^{\circ}\text{C}$
- Diffuser Material: PC
- Operation Ambient Temperature: $-20^{\circ}\text{C}\sim+45^{\circ}\text{C}$
- Luminous Efficiency: 105-110 lumen/watt
- Illuminance Uniformity: >80%
- LED driver position: Built-in
- Luminous Flux: Warm White 4000lm / Cool White v 4300lm / Daylight v 4400lm
- Color Temperature: Warm White 3000-3150K / Cool White 4000-4200K / Daylight 5800-6100K
- LED Lifespan: 50,000 hours
- Warranty: 5 years



Fixture with back wiring



IP65 LED TRI-PROOF LIGHT

LED Linear Linkage Indoor/Outdoor Lights



Item Codes

LLX-T20-(A/D)(30/40/60)-(W/B/S)

2 feet, 20W, 2000-2200 Lumen, Non-Dim/Dim 3000/4000/6000 K

LLX-T40-(A/D)(30/40/60)-(W/B/S)

4 feet, 40W, 4000-4400 Lumen, Non-Dim/Dim 3000/4000/6000 K

LLX-T50-(A/D)(30/40/60)-(W/B/S)

5 feet, 50W, 5000-5500 Lumen, Non-Dim/Dim 3000/4000/6000 K

LLX-T20-(A/D)(30/40/60)-(W/B/S)-BW

2 feet, 20W, 2000-2200 Lumen, Non-Dim/Dim 3000/4000/6000 K, Back wiring

LLX-T40-(A/D)(30/40/60)-(W/B/S)-BW

4 feet, 40W, 4000-4400 Lumen, Non-Dim/Dim 3000/4000/6000 K, Back wiring

LLX-T50-(A/D)(30/40/60)-(W/B/S)-BW

5 feet, 50W, 5000-5500 Lumen, Non-Dim/Dim 3000/4000/6000 K, Back wiring

LLX-MC-(W/M/S) Mounting Clip, color - white/metal/satin

LLX-SSP-5 Suspension Kit 5 feet craft cable

LLX-IJ End to end joiner

LLX-BB-(W/M/S) Binding bracket to secure joining and keep straight, white/metal/satin

LLX-PF-(3/6) Power feed cable 3 feet or 6 feet

LLX-PF-(3/6)-BW Power feed cable 3 feet or 6 feet, Back Wiring

LLX-LC-(3/6) Discrete Link cable 3 feet or 6 feet

LLX-EK End cap

LLX-SSS Silicon sealing sheet on end-to-end joining

IP65 LED TRI-PROOF LIGHT

LED Linear Linkage Indoor/Outdoor Lights



Dimension Cut
Units: Inches and mm
Low Profile: - 5" w, 1.7" h
Length: 2', 4', 5'

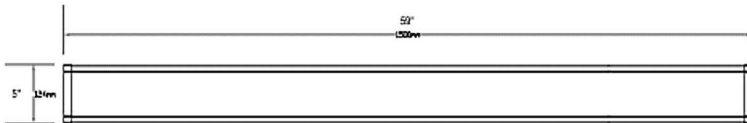
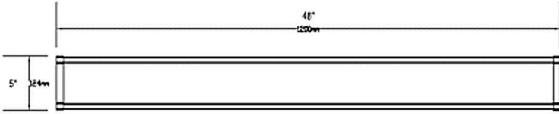
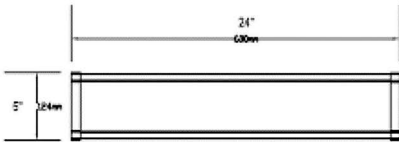
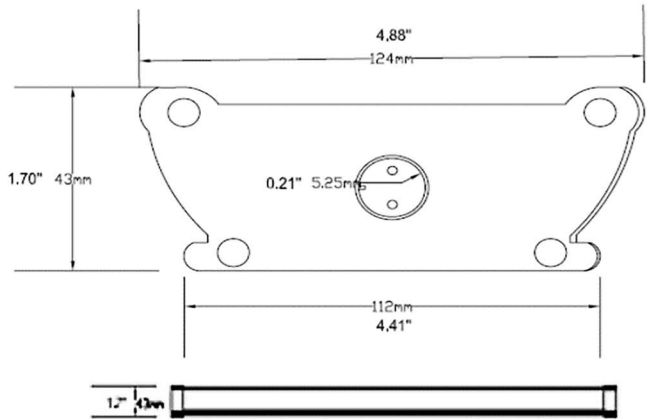

Deep Roof Lighting Inc. 55 Sea Cliff Avenue, Glen Cove, NY 11542 / ph (516) 676-9100 fx (516) 676-9109

Website: www.deeprooflighting.com / Email: cs@deeprooflighting.com

IP55 LED TRI-PROOF LIGHT

LED Linear Linkage Indoor/Outdoor Lights



Direct Mounting or Suspension Mounting Clip

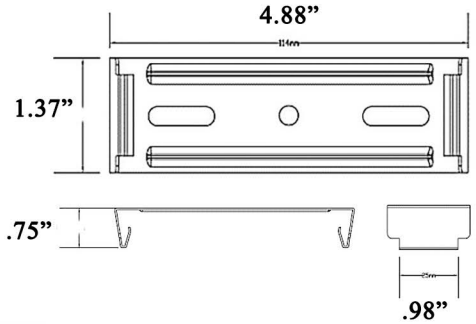

Suspension Kit

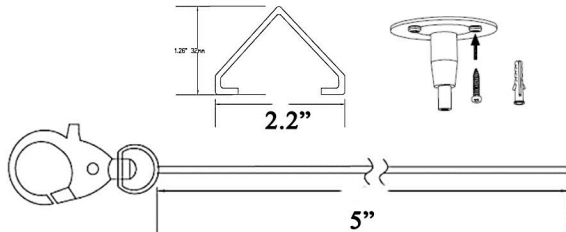

Binding Bracket (white satin paint)

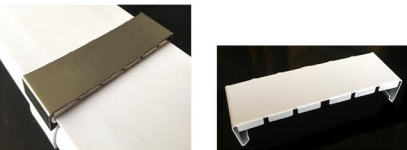

End to End Joiner

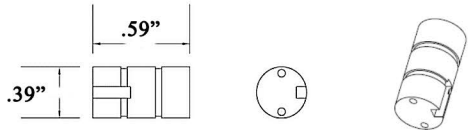
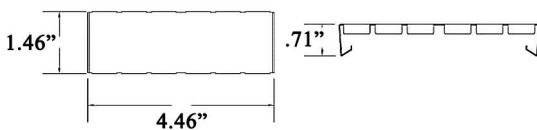
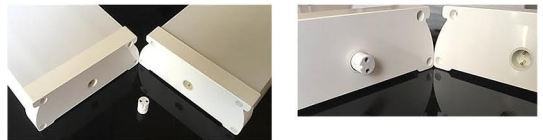

IP65 LED TRI-PROOF LIGHT

LED Linear Linkage Indoor/Outdoor Lights



Link Cable for discrete joining

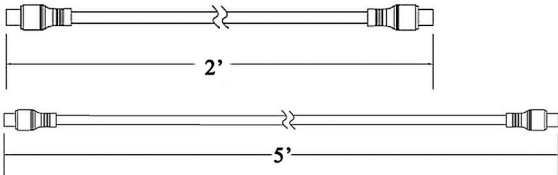

Power Cord With Plug

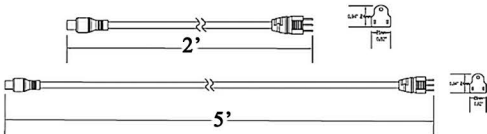

Silicon sealing sheet - Insert into end-to-end joining for outdoor

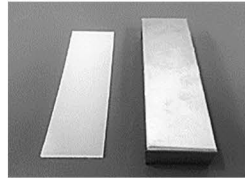

End Cap

